

MPI 1/332/1

Bristol: Plan of the Asylum for 'Lunatics' at Brislington House

1806

This plan is taken from the papers of William Pitt, 1st Earl of Chatham, relating to hospitals and the poor in various English towns. There is no further information provided with the plan, but it dates back to when the asylum was first opened.

Brislington House in Bristol is believed to have been one of the first purpose-built mental asylums in Britain. It was built by Dr Edward Long Fox and opened in 1804. Fox was one of the first asylum owners to use a new treatment for the mentally ill known as moral treatment. This more humane method of treatment became the accepted practice within the Victorian asylum system.

The asylum was a private institution aimed predominantly at an elite clientele. Fox classified the patients according to social class, as can be seen from the floor plan.

Brislington House continued to be run by the Fox family until it closed in 1952.



Garden ground surrounded by Stone wall of 12 feet high

Hot wall, having Four Stoves and Flues to communicate warmth at all times to the Cells of the most furious Patients

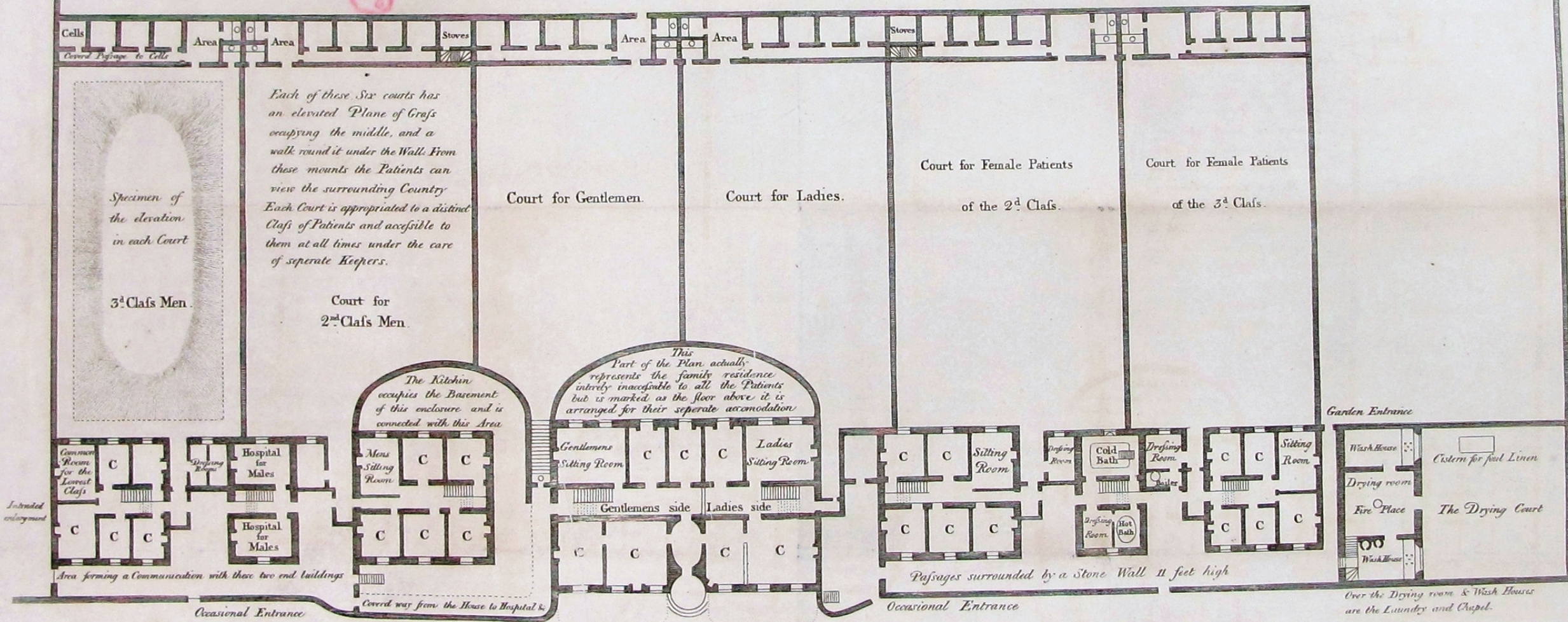
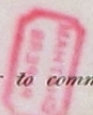

C. Bed Chambers.

The Ground Plan of the ASYLUM for LUNATICS at Brislington House near BRISTOL.

Erected 1806. by D^r Fox.